

FAG

20206-TVP

Barrel roller bearing

Schaeffler ID:
0167017470000Barrel roller bearings 202, main
dimensions to DIN 635-1

Technical information

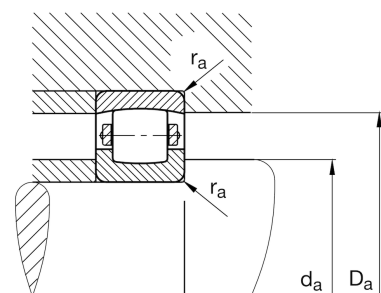
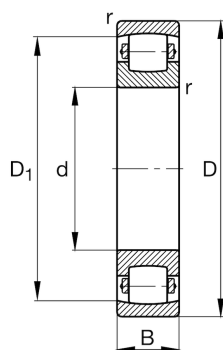
**Main Dimensions & Performance Data**

d	30 mm	Bore diameter
D	62 mm	Outside diameter
B	16 mm	Width
C_r	28,000 N	Basic dynamic load rating, radial
C_{0r}	28,500 N	Basic static load rating, radial
C_{ur}	2,950 N	Fatigue load limit, radial
n_G	10,800 1/min	Limiting speed
	0.204 kg	Weight

Dimensions

r_{min}	1 mm	Minimum chamfer dimension
D_1	53 mm	Bore diameter outer ring

Mounting dimensions

$d_{a min}$	35.6 mm	Minimum diameter shaft shoulder
$D_{a max}$	56.4 mm	Maximum diameter of housing shoulder
$r_{a max}$	1 mm	Maximum recess radius

Temperature range

T_{min}	-30 °C	Operating temperature min.
T_{max}	120 °C	Operating temperature max.